

9th EDITION

REFERENCE MANUAL

CONSTRUCTION SPECIALTY CASTINGS

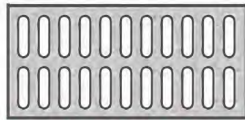

Trench Grates & Frame



Pipe Grates

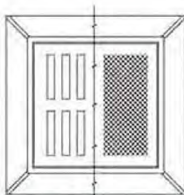

Catch Basins

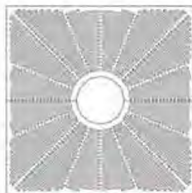

Tree Grates

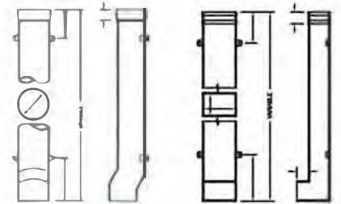

Downspout Boots



Manhole Rings & Covers

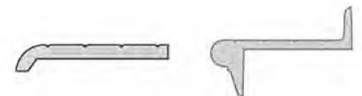

Cast Iron
Nosings/Treads/Thresholds



65 Years Serving the
Construction Industry

Trench Grates • Downspout Boots • Nosings • Treads • Tree Grates
Gray Cast Iron • Ductile Cast Iron • Cast Aluminum

Barry Pattern & Foundry Company, Inc.

3333 35th Avenue North, Birmingham, AL 35207

Toll- Free 1-800-524-1809

Fax: 205-841-1972

Loadings shown are for Gray and Ductile Cast Iron.
For aluminum covers and grates: If H-20 Loading is required – it must be specified.

OVER SIXTY YEARS



EXPERIENCE & SERVICE

For all purposes: from the simplest to the most complex casting needs...



BarryCraft manufactures quality trench grating for virtually any requirement or need that you may have – from the simplest to the most complex casting needs.

BarryCraft is dedicated to providing the personal service that you need. You will find very quickly that we care about our customers.



BarryCraft is committed to provide the best service, to sell competitively and to meet your needs.

BarryCraft Specifications Meet:

- ASTM (American Society for Testing and Materials) standards.
- Federal Government Standards (RR-F-621C)
- AASHTO (American Association of State Highway and Transportation Official) standards.
- BarryCraft provides load capacities including impact and free open area data on virtually all of our grating.

Short Form Specifications & Service Information

Gray cast iron

Gray cast iron trench grating/solid covers and frames shall be as manufactured by Barry Pattern and Foundry (BarryCraft), Birmingham, Alabama. Gray cast iron used in the manufacture of trench grating or solid covers and frames shall conform to ASTM A48-83 CLASS 35. All castings shall be of uniform quality, free from blow holes, shrinkage defects, swells, cracks or other defects. Casting will be free of fins, burrs and slag.

Ductile cast iron

Ductile cast iron trench grating or solid covers (frames furnished in gray cast iron unless specified ductile cast iron) shall be as furnished by Barry Pattern and Foundry (BarryCraft), Birmingham, Alabama. Ductile cast iron used in the manufacture of trench grating or solid covers and frames shall conform to ASTM A536-80 grade 65-45-12. All castings shall be of uniform quality, free from blow holes, shrinkage defects, swells, cracks or other defects. Casting will be free of fins, burrs and slag.

Cast aluminum

Cast aluminum trench grating or solid covers and frames shall be as manufactured by Barry Pattern and Foundry (BarryCraft), Birmingham, Alabama. Cast aluminum used in the manufacture of trench grating or solid covers and frames shall be alloy 319 meeting Federal Specifications QQ-A-601 and ASTM B-26. All castings shall be of uniform quality, free from blow holes, shrinkage defects, swells, cracks or other defects. Casting will be free of fins, burrs and slag. Cast aluminum will be natural sand-cast finish. H-20 loading must be specified if required.

Our Newest Product



PATENT #4,993,877

We proudly introduce our newest product...

Consider the advantages:

Cost Savings

- Labor costs drastically reduced.
- Less forming material – less cost.

Simple Installation

- Personnel inexperienced in forming can easily install.
- Frames attach simply without the use of wire, nails and seat forms.
- Quickly adjusts for leveling.
- Frames easily cut in the field.
- Frames easily welded in the field.

A Superior Frame Design That Produces Quality Trench Installation

- Insures level frame installation.
- Provides superior anchorage in concrete.
- Reduces risk of spalling of concrete underframes.
- Continuous bearing surface with fewer joints.
- Supplied in standard 4'0" lengths or special 8'0" lengths if required.
- Excellent with brick pavers and tile.
- Galvanized steel.

Unique features for high-quality, low-cost, time-saving installation:

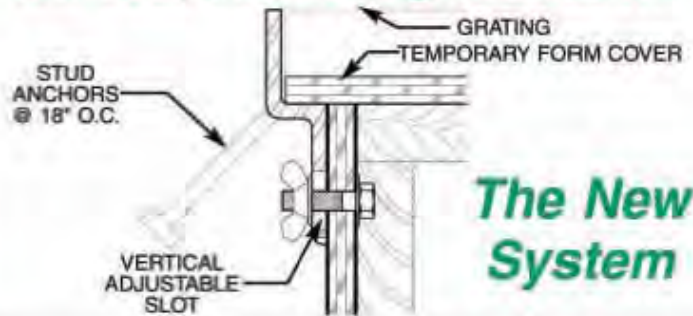

The New System

Align E-Z frame bearing surface along top edge of plywood wall form and scribe each slot.

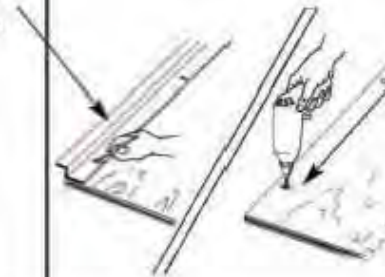

Drill holes in center of the slot.

Mount frame to form using 1/4" nuts and bolts.

Frame should be tightened enough to be adjustable.

Nail pre-fabricated 2" x 4" box form braces to sidewalls of 3/4" weather resistant plywood. Boxes may be toenailed for future use or nailed from the outside.



Box height is staggered: flush with bearing surface where spreaders are used.

Lower boxes for bottom support

When positioned in trench, leveling is easily and quickly accomplished.

One suggested method is to position one side and tighten the bolts and nuts. Take a piece of flat steel (the grate width by 24") or use an actual grate, placing it within the frame.

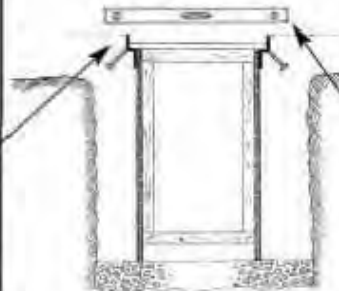

Raise or lower the loose frame until the leveling is assured, then tighten the bolts and install the spreaders.

Your level is guaranteed virtually perfect. It works – it is easy!

Gray Cast Iron Standard Designs

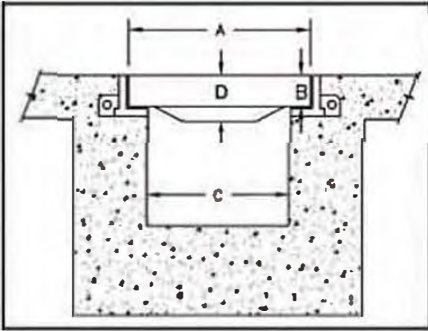

The above illustration, found also on the following pages, shows only basic dimensions, and does not apply to all cover designs. Bar depths, seating widths and center thickness may vary on different styles and sizes.

Gray Cast Iron is an excellent and economical material for use in areas where heavy or light wheel loadings do not subject the grates or covers to extreme shock levels. Gray Cast Iron exhibits good corrosion resistance in road wear areas. BarryCraft Construction Casting Company has provided you with loading tables to enable you to select exactly what you require.

Note: The wheel load selection including impact (such as H-20) is your most important consideration. If H-20 loading is required on aluminum – it must be specified.



Quality Products

Call Us Toll Free:
1-800-524-1809
Fax: 205-841-1972

Grates For Heavy Loads

H-20 Loading Trench Grates/Covers/Frames B-H20G Series	TABLE: Dimensions in inches				Open Area /2'0" section	
	Trench Grating Style	Grate Width "A"	Edge Thickness "B"	Trench Width "C"	Square Inches	Percent
H-20 design provides for (on each 2'0" section of grate): (1) two wheel loads of 9,000# + 3,000# of impact per wheel; or (2) a single wheel load of 24,000# (including impact). Our heavy duty grates and frames are designed for warehouse trucks, concrete mixers and tractor trailers.	B-H20G-A	8	1½	6	78	54%
	B-H20G-B	10	1½	8	91	47%
	B-H20G-C	12	1½	10	117	49%
	B-H20G-D	14	1½	12	143	50%
	B-H20G-E	17	1½	15	182	51%
	B-H20G-F	20	1½	18	221	51%
	B-H20G-G	23	1½	21	260	52%
	B-H20G-H	26	1½	24	248	43%
	B-H20G-J	30	2	27	282	44%
	B-H20G-K	33	2	30	317	44%
	B-H20G-L	36	2	33	351	44%
	B-H20G-M	39	2	36	377	44%
	B-H20G-N	45	2	42	441	44%
	B-H20G-O	51	2	48	510	44%

Grates For Lighter Loads



H-15 Loading Trench Grates/Covers/Frames B-H15G Series	TABLE: Dimensions in inches				Open Area /2'0" section	
	Trench Grating Style	Grate Width "A"	Edge Thickness "B"	Trench Width "C"	Square Inches	Percent
H-15 design provides for (on each 2'0" section of grate): (1) two wheel loads of 6,750# + 2,250# of impact per wheel; or (2) a single wheel load of 18,000# (including impact). Our medium heavy duty grates and frames are excellent for truck cranes with pneumatic tires and where usual highway and industrial loading occur.	B-H15G-A	8	1½	6	78	54%
	B-H15G-B	10	1½	8	91	47%
	B-H15G-C	12	1½	10	117	49%
	B-H15G-D	14	1½	12	143	50%
	B-H15G-E	17	1½	15	182	51%
	B-H15G-F	20	1½	18	221	51%
	B-H15G-G	23	1½	21	260	52%
	B-H15G-H	26	1½	24	248	43%
	B-H15G-J	30	2	27	282	44%
	B-H15G-K	33	2	30	317	44%
	B-H15G-L	36	2	33	351	44%
	B-H15G-M	39	2	36	377	44%
	B-H15G-N	45	2	42	441	44%
	B-H15G-O	51	2	48	510	44%

Gray Cast Iron Standard Designs



Grates For Lighter Loads



H-10 Loading Trench Grates/Covers/Frames B-H10G Series	TABLE: Dimensions in inches				Open Area /2'0" section	
	Trench Grating Style	Grate Width "A"	Edge Thickness "B"	Trench Width "C"	Square Inches	Percent
<p>H-10 design provides for (on each 2' 0" section of grate):</p> <ul style="list-style-type: none"> (1) two wheel loads 2'0" of 4,500# + 1,500# of impact per wheel; or (2) a single wheel load of 12,000# (including impact). <p>Our medium duty grates and frames are excellent for vehicles such as for light trucks, automobiles and dollies.</p>	B-H10G-A	8	1½	6	78	54%
	B-H10G-B	10	1½	8	91	47%
	B-H10G-C	12	1½	10	117	49%
	B-H10G-D	14	1½	12	143	50%
	B-H10G-E	17	1½	15	182	51%
	B-H10G-F	20	1½	18	221	51%
	B-H10G-G	23	1½	21	260	52%
	B-H10G-H	26	1½	24	248	43%
	B-H10G-J	30	1½	27	282	44%
	B-H10G-K	33	1½	30	317	44%
	B-H10G-L	36	1½	33	351	44%
	B-H10G-M	39	1½	36	377	44%
	B-H10G-N	45	1½	42	441	44%
B-H10G-O	51	1½	48	510	44%	

1000 Pound Loading Trench Grates/Covers/Frames	TABLE: Dimensions in inches				Open Area /2'0" section	
	Trench Grating Style	Grate Width "A"	Edge Thickness "B"	Trench Width "C"	Square Inches	Percent
<p>Light duty trench grates, covers and frames are recommended for applications where maximum wheel loads do not exceed 1,000 pounds.</p> <p>In addition to areas with light traffic, these grates are also excellent for pedestrian traffic. They are functional and yet attractive enough for the most demanding eye.</p>	B-1000G-A	8	1½	6	78	54%
	B-1000G-B	10	1½	8	91	47%
	B-1000G-C	12	1½	10	117	49%
	B-1000G-D	14	1½	12	143	50%
	B-1000G-E	16	1½	14	182	51%
	B-1000G-F	18	1½	16	221	51%
	B-1000G-G	20	1½	18	260	52%
	B-1000G-H	24	1½	22	248	43%
	B-1000G-J	26	1½	24	282	44%

***Note:** 1,000 pound loading trench grates and covers are supplied with 1½" edge thickness for use with "L" frame installations. "EZ" frames are also available. Type "L1" frames also available for 3/4" cover thickness. Please specify edge thickness and frame type when ordering.

Ductile Cast Iron Standard Designs

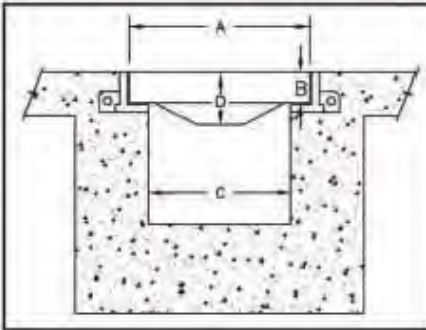

- A = Grate/Cover Width
- B = Edge Thickness
- C = Trench Width
- D = Varies with Load Required

Ductile Cast Iron is an excellent material to be used in areas where heavy or light wheel loading subject extreme and sudden levels of shock to the grates/covers. Ductile Cast Iron by nature will bend slightly, absorbing extreme and sudden impacts. Ductile Cast Iron exhibits essentially the same corrosive resistance as Gray Cast Iron.

Please note: Load strength is in the grate itself. Ductile grates are furnished with gray cast iron frames with no sacrifice in load strength. Ductile iron frames can be furnished - but must be specified.

100 Ton loading is available in type "A" grates and type "D" covers with type "L" Frames only.

BarryCraft Construction Casting Company has provided you with load tables to enable you to select exactly what you need.



Grates For Extremely Heavy Loads Available in Type "A" or "D" Covers Only in Type "L" Frame Only

60 Ton Wheel Load Trench Grates/Covers/ Frames B-60TD Series	TABLE: Dimensions in inches				Open Area/2'0" section	
	Trench Grating Style	Grate Width "A"	Edge Thickness "B"	Trench Width "C"	Square Inches	Percent
This design provides for (on each 2' section of grate). (1) a single wheel load of 60 Tons (120,000#) + 24,000# of impact, equaling a total wheel load of 144,000#.	B-60TD-A	8	1½	6	78	54%
	B-60TD-B	10	1½	8	91	47%
	B-60TD-C	12	1½	10	117	49%
	B-60TD-D	15	2	12	143	50%
	B-60TD-E	18	2	15	182	51%
	B-60TD-F	21	2	18	221	51%
	B-60TD-G	24	2	21	260	52%
	B-60TD-H	27	2	24	248	43%
	B-60TD-J	30	2	27	282	44%
	B-60TD-K	33	2	30	317	44%
	B-60TD-L	36	2	33	351	44%
	B-60TD-M	39	2	36	377	44%
	B-60TD-N	45	2	42	441	44%
	B-60TD-O	51	2	48	510	44%

Our extra heavy duty grates and frames are recommended in areas subjected to extremely heavy loads and shock levels. They are excellent in areas subjected to heavy aircraft, heavy dock cranes, military vehicles and very heavy earthmoving equipment.

40 Ton Wheel Load Trench Grates/ Covers/Frames B-40TD Series	TABLE: Dimensions in inches				Open Area/2'0" section	
	Trench Grating Style	Grate Width "A"	Edge Thickness "B"	Trench Width "C"	Square Inches	Percent
This design provides for (on each 2'0" section of grate): (1) a single wheel load of 40 Tons (80,000#) + 16,000# of impact, equaling a total wheel load of 96,000#.	B-40TD-A	8	1½	6	78	54%
	B-40TD-B	10	1½	8	91	47%
	B-40TD-C	12	1½	10	117	49%
	B-40TD-D	15	2	12	143	50%
	B-40TD-E	18	2	15	182	51%
	B-40TD-F	21	2	18	221	51%
	B-40TD-G	24	2	21	260	52%
	B-40TD-H	27	2	24	248	43%
	B-40TD-J	30	2	27	282	44%
	B-40TD-K	33	2	30	317	44%
	B-40TD-L	36	2	33	351	44%
	B-40TD-M	39	2	36	377	44%
	B-40TD-N	45	2	42	441	44%
	B-40TD-O	51	2	48	510	44%

Our extra heavy duty grates and frames are recommended in areas subjected to extremely heavy loads and shock levels. They are excellent in areas subjected to heavy aircraft, heavy dock cranes, military vehicles and very heavy earth moving equipment.

Ductile Cast Iron Standard Designs



20 Ton Wheel Load Trench Grates/ Covers/ Frames B-20TD Series	TABLE: Dimensions in inches				Open Area/2'0" section	
	Trench Grating Style	Grate Width "A"	Edge Thickness "B"	Trench Width "C"	Square Inches	Percent
<p>This design provides for (on each 2'0" section of grate):</p> <p>(1) a single wheel load of 20 tons (40,000#) + 8,000# of impact, equaling a total wheel load of 48,000#.</p> <p>Our extra heavy duty grates and frames are recommended in areas subjected to extremely heavy loads and shock levels. They are excellent in areas subjected to heavy aircraft, heavy dock cranes, military vehicles and very heavy earth moving equipment.</p>	B-20TD-A	8	1½	6	78	54%
	B-20TD-B	10	1½	8	91	47%
	B-20TD-C	12	1½	10	117	49%
	B-20TD-D	14	1½	12	143	50%
	B-20TD-E	17	1½	15	182	51%
	B-20TD-F	20	1½	18	221	51%
	B-20TD-G	23	1½	21	260	52%
	B-20TD-H	26	1½	24	248	43%
	B-20TD-J	30	2	27	282	44%
	B-20TD-K	33	2	30	317	44%
	B-20TD-L	36	2	33	351	44%
	B-20TD-M	39	2	36	377	44%
	B-20TD-N	45	2	42	441	44%
	B-20TD-O	51	2	48	510	44%

Grates For Heavy Loads



H-20 Loading Trench Covers/Grates/ Frames B-H20D Series	TABLE: Dimensions in inches				Open Area/2'0" section	
	Trench Grating Style	Grate Width "A"	Edge Thickness "B"	Trench Width "C"	Square Inches	Percent
<p>H-20 design provides for (on each 2'0" section of grate):</p> <p>(1) two wheel loads of 9,000# + 3,000# of impact per wheel; or</p> <p>(2) a single wheel load of 24,000# (including impact).</p> <p>Our heavy duty grates and frames are designed for warehouse trucks, concrete mixers, tractor trailers and heavy forklifts.</p>	B-H20D-A	8	1½	6	78	54%
	B-H20D-B	10	1½	8	91	47%
	B-H20D-C	12	1½	10	117	49%
	B-H20D-D	14	1½	12	143	50%
	B-H20D-E	17	1½	15	182	51%
	B-H20D-F	20	1½	18	221	51%
	B-H20D-G	23	1½	21	260	52%
	B-H20D-H	26	1½	24	248	43%
	B-H20D-J	30	2	27	282	44%
	B-H20D-K	33	2	30	317	44%
	B-H20D-L	36	2	33	351	44%
	B-H20D-M	39	2	36	377	44%
	B-H20D-N	45	2	42	441	44%
	B-H20D-O	51	2	48	510	44%

Cast Aluminum Standard Designs

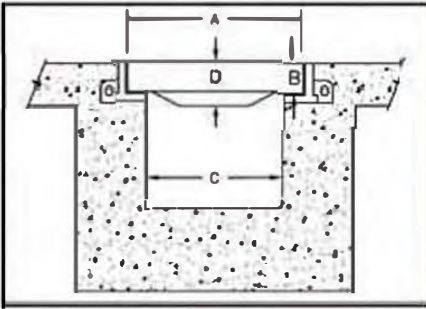

A = Grate/Cover Width
 B = Edge Thickness
 C = Trench Width
 D = Varies With Load Required

Call Us Toll Free:
 1-800-524-1809
 Fax: 205-841-1972

Cast Aluminum Trench Grates/Covers/Frames offer an attractive maintenance free method of providing drainage for the most demanding eye. Cast aluminum's resistance to salt water is also outstanding.

Frequent uses include: swimming pool areas, sidewalks, shopping malls, restaurants, kitchen facilities, industrial plants and greenhouses. Cast Aluminum Grates/Covers can be furnished in Heavy loading but the loading must be specified.

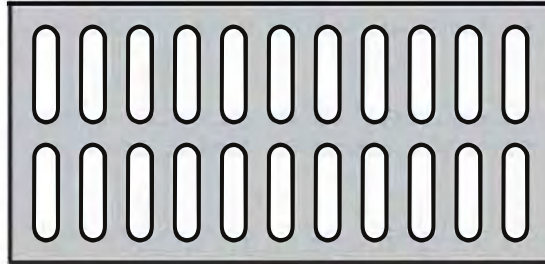

Grates For Lighter Loads



H-10 Loading Trench/Grates/Covers/Frames B-H10A Series	TABLE: Dimensions in inches				Open Area/2'0" section	
	Trench Grating Style	Grate Width "A"	Edge Thickness "B"	Trench Width "C"	Square Inches	Percent
H-10 design provides for (on each 2'0" section of grate): (1) two wheel loads of 4,500# each + 1,500# of impact per wheel: or (2) a single wheel load of 12,000# (including impact). Our medium duty grates and frames are excellent for light vehicle and pedestrian traffic.	B-H10A-A	8	1½	6	78	51%
	B-H10A-B	10	1½	8	91	47%
	B-H10A-C	12	1½	10	117	49%
	B-H10A-D	14	1½	12	143	50%
	B-H10A-E	17	1½	15	182	51%
	B-H10A-F	20	1½	18	221	51%
	B-H10A-G	23	1½	21	260	52%
	B-H10A-H	26	1½	24	248	43%
	B-H10A-J	30	1½	27	282	44%
	B-H10A-K	33	1½	30	317	44%
	B-H10A-L	36	1½	33	351	44%
	B-H10A-M	39	1½	36	377	44%
	B-H10A-N	45	1½	42	441	44%
B-H10A-O	51	1½	48	510	44%	

1000 Pound Loading Trench Grates/Covers/Frames B-1000A Series	TABLE: Dimensions in inches				Open Area/2'0" section	
	Trench Grating Style	Grate Width "A"	Edge Thickness "B"	Trench Width "C"	Square Inches	Percent
1000 pound loading design provides (on each 2'0" section of grate): (1) a single wheel load of 1,000# + 500# of impact. Light duty trench grates and frames are excellent for pedestrian traffic or where the loading does not exceed the 1,000 pound loading classification.	B-1000A-A	8	1½	6	78	51%
	B-1000A-B	10	1½	8	91	47%
	B-1000A-C	12	1½	10	117	49%
	B-1000A-D	14	1½	12	143	50%
	B-1000A-E	17	1½	15	182	51%
	B-1000A-F	20	1½	18	221	51%
	B-1000A-G	23	1½	21	260	52%
	B-1000A-H	26	1½	24	248	43%

*Note: 1,000 pound loading trench grates and covers are supplied with 1½" edge thickness for use with "L" frame installations. "EZ" frames available. Type "L1" frames are available for 3/4" cover thickness. Please specify edge thickness and frame type when ordering.

Pedestrian - Handicap/Bicycle Trench Grating

Pedestrian Trench Grating



Call Us Toll Free:
1-800-524-1809
Fax: 205-841-1972

BarryCraft's "pedestrian" trench grating (type HH design: see Page 11) is a new improved trench grate design for pedestrian traffic. The 5/16" wide slot helps to provide safer grating to walk on in the areas where drainage is required. When specifying or ordering BarryCraft's "pedestrian" grating, please remember to indicate the type of material required. BarryCraft offers you three choices:

- Gray cast iron
- Ductile cast iron
- Cast aluminum

The type L frame is standard and will be provided with the pedestrian grating when a frame is specified.

Applications for BarryCraft's "pedestrian" grating include: sidewalks, terraces, shopping malls, around swimming pools and other areas where appearance and public safety are important.

TABLE: Dimensions in inches

Trench Grating Style	Grate Width "A"	Edge Thickness "B"	Trench Width "C"
B-PED-A1	6	1½	4
B-PED-A2	8	1½	6
B-PED-A3	10	1½	8
B-PED-A4	12	1½	10
B-PED-A5	14	1½	12

*Note: "Pedestrian" trench grating are supplied with 1½" edge thickness for use with "L" frame installations. Type "L1" frames are available for 3/4" cover thickness. "EZ" frames are also available. Please specify edge thickness and frame type when ordering.

Handicap/Bicycle Trench Grating

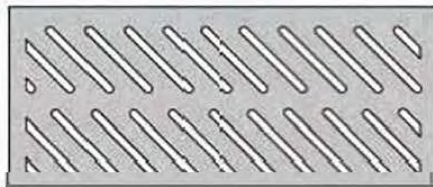

BarryCraft's "handicapped/bicycle" trench grating (type AAA design: see Page 11) is designed to help ease handicap and bicycle traffic safely over trench grating installations. BarryCraft's "handicapped/ bicycle" trench grating's standard diagonal slots are 3/8" wide with a maximum slot length of 9". Grates and frames may be ordered or specified in:

- Gray cast iron
- Ductile cast iron
- Cast aluminum

The type L frame (see page 11) is standard and will be provided with the Handicapped/bicycle grating when a frame is specified.

BarryCraft's "handicapped/bicycle" trench grating is particularly suitable in any public area where handicapped and others on small tire traffic have access. Such areas include hospitals, schools, office buildings, colleges, public sidewalks and shopping malls.

TABLE: Dimensions in inches

Trench Grating Style	Grate Width "A"	Edge Thickness "B"	Trench Width "C"
B-HCB-A1	6	1½	4
B-HCB-A2	8	1½	6
B-HCB-A3	10	1½	8
B-HCB-A4	12	1½	10
B-HCB-A5	14	1½	12

*Note: "Handicapped/bicycle" trench grating are supplied with 1½" edge thickness for use with "L" frame installations. Type "L1" frames are available for 3/4" cover thickness. "EZ" frames are also available. Please specify edge thickness and frame type when ordering.

Catch Basin Drainage Grates & Frames

Typical Uses

As catch basins at the end of a trench
 As individual drainage gates
 As curb inlets



All grates are designed for strength and service. Any grate listed can be furnished with an angle frame as illustrated above when specified. Almost any size grate

not listed can be furnished. Grates are available in gray cast iron, ductile cast iron or cast aluminum. H-20 loading must be specified. If it is required.

Light Duty	
1 inch edge thickness	
Catalog No.	Dimensions
B-5306	8 x 8
B-5308	8 x 12
B-5312	8 x 24
B-5318	9 x 9
B-5324	10 x 10
B-5328	10 x 24
B-5336	11 x 24
B-5342	12 x 12
B-5346	12 x 18
B-5350	12 x 24
B-5358	14 x 14
B-5362	14 x 24
B-5366	15 x 15
B-5371	15 x 24
B-5372	16 x 16
B-5373	16 x 24
B-5374	18 x 18
B-5376	18 x 24
B-5378	18 x 30
B-5380	18 x 36
B-5384	20 x 20
B-5386	20 x 24
B-5390	24 x 24
B-5391	24 x 30
B-5392	24 x 36
B-5393	26 x 26
B-5394	28 x 28
B-5395	30 x 30

Medium Duty	
1½ inch edge thickness	
Catalog No.	Dimensions
B-5503	6 x 24
B-5505	8 x 24
B-5507	9 x 24
B-5508	10 x 10
B-5510	10 x 24
B-5511	11 x 24
B-5514	12 x 12
B-5516	12 x 18
B-5518	12 x 24
B-5521	13 x 24
B-5523	14 x 14
B-5526	14 x 24
B-5528	15 x 15
B-5529	15 x 24
B-5532	16 x 16
B-5534	16 x 24
B-5536	18 x 18
B-5538	18 x 24
B-5551	19 x 24
B-5554	20 x 20
B-5556	20 x 24
B-5559	21 x 24
B-5561	22 x 24
B-5566	24 x 24
B-5568	24 x 30
B-5570	24 x 36
B-5572	24 x 48
B-5576	26 x 26
B-5578	28 x 28
B-5582	30 x 30
B-5586	32 x 32
B-5590	36 x 36

Heavy Duty	
2 inch edge thickness	
Catalog No.	Dimensions
B-5702	8 x 24
B-5710	10 x 10
B-5712	10 x 24
B-5714	12 x 12
B-5715	12 x 24
B-5732	14 x 24
B-5742	15 x 24
B-5744	16 x 16
B-5748	16 x 24
B-5751	17 x 24
B-5752	18 x 18
B-5753	18 x 24
B-5756	18 x 36
B-5757	19 x 24
B-5758	20 x 20
B-5759	20 x 24
B-5760	20 x 30
B-5763	21 x 21
B-5764	22 x 22
B-5765	22 x 24
B-5768	24 x 24
B-5771	24 x 30
B-5773	24 x 36
B-5776	24 x 48
B-5782	26 x 26
B-5783	27 x 27
B-5788	28 x 28
B-5790	30 x 30
B-5791	30 x 36
B-5792	32 x 32
B-5793	34 x 34
B-5794	36 x 36
B-5796	39 x 39

Standard Frame Types

E-Z frames are high quality, at a low cost and are simple to install.

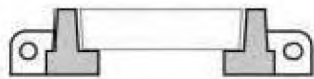

Type "L"
Type "L" frame-standard
and most popular!

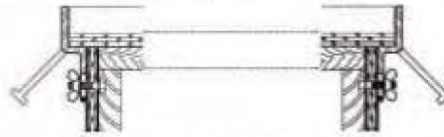

Type E-Z
Most simple to install.

Standard Grate & Cover Designs

Available in Gray, Ductile Cast Iron, Aluminum

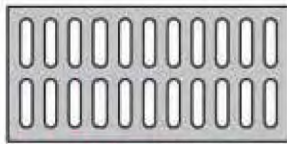

Type "A" Grate (slots run perpendicular to frame). Recommended for highest strength and lowest cost.

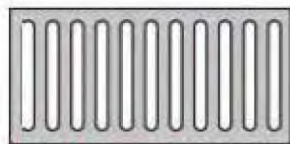

Type "B" Grate (slots perpendicular to frame.)



Type "C" Grate (slots parallel to frame.)

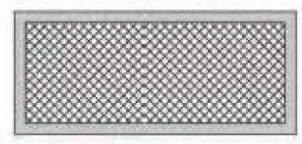

Type "D" Solid Cover. Abrasive grit available.

New!

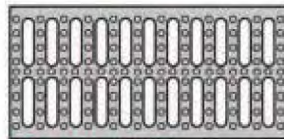

Type "AK" Grate (slots run perpendicular to frame). Recommended for highest strength and lowest cost with raised knobs to improve drainage and traction.

New grate designs for safety!



Type "AAA"
(slots run diagonal to frame. For handicap/bicycle safety.)



Type "HH" Grate
(slots run perpendicular to frame. Slots to 5/16" wide for pedestrian traffic.)



Type "W" Wave Grates.

Safer for wheelchairs and bicycles!
Excellent drainage from all directions.
Strength designs for light wheelchair/ bicycle traffic up to aircraft traffic.



Safer for pedestrian traffic.
Strength designs for light pedestrian traffic up to aircraft traffic.

Bolting Details

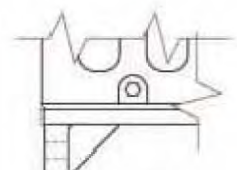
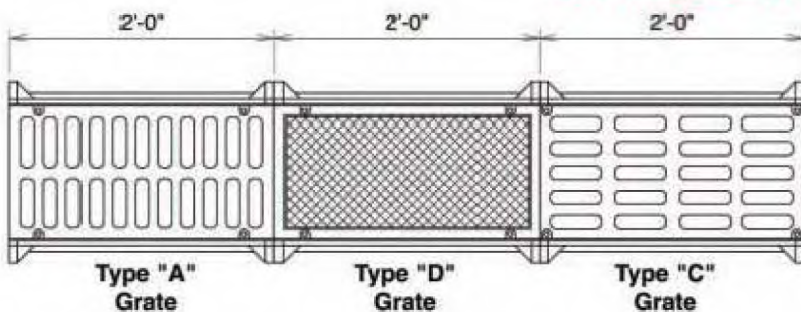

Top View



Type "L" Frame

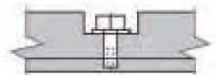

Side View



Construction Casting Company
800-524-1809

Standard Manhole Rings & Covers

H-20 Loading

H-20 design provides for:

- (1) two wheel loads of 9,000 lbs.
+ 3,000 lbs. of impact per wheel or
- (2) a single wheel load of 24,000 lbs.

H-20 products are designed for warehouse trucks, concrete mixers, tractor trailers and heavy forklifts.

1,000 lb. loading

Light duty products are recommended for applications where maximum wheel loads do not exceed 1,000 pounds. In addition to

areas with light traffic, these products are also excellent for pedestrian traffic.

Other loadings available upon request.

More Options

Manhole options available: with all Barrycraft standard designs.

Strength: We offer light duty standard designs (1000 lb. loadings) to heavy duty designs (H-20). Other loadings are available upon request.

Cover designs: Each standard design can be solid, grated, vented or bolted and gas-

ket sealed for water tight needs.

Custom made cover designs: Virtually any design is available upon request.

Lettering: We can letter the cover with virtually whatever you need at a low cost.

Locking devices: We offer outside hinge and hasp or a bolted cover.

Lifting devices: We offer the standard pickhole, steel lifting bar, steel drop through handle, cast in handle (for watertight manholes).

For Heavy Duty - Specify "H"
For Light Duty - Specify "L"
For H-20 Loading - Specify "H-20"

Round B1600 Series - Bottom Flange

H-20 Loading	For Heavy Loads				
Table Dimensions in Inches					
Manhole Style	Cover Diameter "A"	Cover Thickness "B"	Clearing Opening "C"	Ring Overall "E"	Wt. lbs.
B-1600-A	20	1 3/4	18	30	341
B-1600-B	22	1 3/4	20	32	369
B-1600-C	24	1 3/4	22	34	381
B-1600-D	26	1 3/4	24	36	459
B-1600-E	29	1 3/4	27	39	551
B-1600-F	32	1 3/4	30	42	616
B-1600-G	38	1 3/4	36	48	708

Large Manhole Covers

B-1600 and B-1602 are our most popular manhole series, with standard seven inch deep frames.

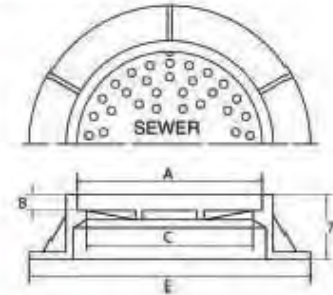

Round B6001 Series - Top Flange

1,000 Lb. Loading	For Light Loads / Table Dimensions in Inches					
Manhole Style	Cover Diameter "A"	Cover Thickness "B"	Clearing Opening "C"	Ring Overall "D"	Ring Height "E"	Wt. lbs.
B-6001	6	3/4	5	10	4	22
B-6003	9	3/4	8	12	4	35
B-6005	12 3/4	3/4	11	14 3/4	4	48
B-6006	13	3/4	11 3/4	17	4	82
B-6007	14	3/4	12	20	4	88
B-6008	16	3/4	15	20 1/4	4	84
B-6009	18	3/4	16 1/2	21 3/4	4	97
B-6010	18	3/4	16 1/2	22 1/2	4	98
B-6011	18	3/4	17	22 1/2	4	102
B-6012	20 1/2	3/4	18	24	4	131
B-6020	21 1/2	3/4	20	27	4	140
B-6034	24	3/4	22	26 1/2	4	143
B-6040	24	3/4	22	30	4	147
B-6044	25	3/4	22	28	4	174
B-6044-A	26 1/2	3/4	25 1/2	30 1/2	4	165
B-6050	27	3/4	24	33 1/2	4	190
B-6070	27	3/4	25	31	4	180
B-6077	32	3/4	30	36 1/2	4	244
B-6077-A	32	3/4	30	36 1/2	4	288
B-6080	34	3/4	32	37	4	240
B-6090	37 1/2	3/4	36	42 1/2	4	328

Catch Basin Frames & Grates

Light Duty ring and cover or grate for slab construction. Excellent over pits and catch basins.

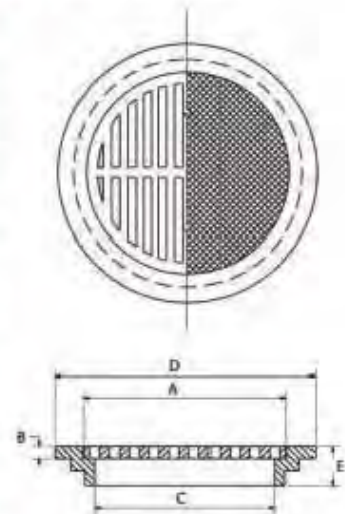

Loadings shown are for Gray and Ductile Cast Iron. For aluminum covers and grates: If H-20 Loading is required - it must be specified.

Round

B1792 & B1793 Series - Bottom Flange

H-20 Loading		For Heavy Loads						
Table Dimensions in Inches								
Manhole Style (Solid Lid)	Manhole Style (Grate Lid)	Cover Diameter "A"	Cover Edge "B"	Clear Opening "C"	Base Opening "D"	Ring Overall "E"	Ring Height "F"	Wt. lbs.
B-1792-AL	B-1792-AG	10 1/4	1 1/2	8 1/2	10 1/4	14 1/4	4	79
B-1792-BL	B-1792-BG	13 1/4	1 1/2	11 1/2	13 1/4	17 1/4	4	104
B-1792-CL	B-1792-CG	16 1/4	1 1/2	14 1/2	16 1/4	20 1/4	4	136
B-1792-DL	B-1792-DG	18 1/4	1 1/2	16 1/2	18 1/4	22 1/4	4	181
B-1792-EL	B-1792-EG	22 1/4	1 1/2	20 1/2	22 1/4	26 1/4	4	243
B-1792-FL	B-1792-FG	25 1/4	1 1/2	23 1/2	25 1/4	29 1/4	4	278
B-1792-GL	B-1792-GG	28 1/4	1 1/2	26 1/2	28 1/4	32 1/4	4	341
B-1792-HL	B-1792-HG	34 1/4	1 1/2	32 1/2	34 1/4	38 1/4	4	421
B-1792-JL	B-1792-JG	40 1/4	1 1/2	38 1/2	40 1/4	44 1/4	4	556
B-1792-KL	B-1792-KG	46 1/4	1 1/2	44 1/2	46 1/4	50 1/4	4	729

B-1792 and B-1793 have four inch deep frames. These are excellent in areas where deep paving is not required.

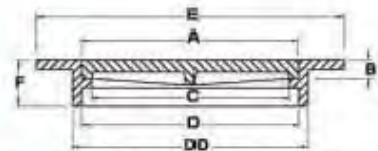
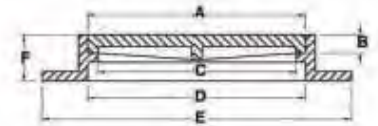

B-1892 top flange series are used in concrete slabs. Many styles also fit corrugated plastic or metal pipe.

For Heavy Duty - Specify "H"
For Light Duty - Specify "L"
For H-20 Loading - Specify "H-20"

Loadings shown are for Gray and Ductile Cast Iron.
 For aluminum covers and grates: If H-20 Loading is required - it must be specified.

B1892 & B1893 Series - Top Flange

H-20 Loading		For Heavy Loads						
Table Dimensions in Inches								
Manhole Style (Solid Lid)	Manhole Style (Grate Lid)	Cover Diameter "A"	Cover Edge "B"	Clear Opening "C"	Base Opening "D"	Ring Overall "E"	Ring Height "F"	Wt. lbs.
B-1892-AL	B-1892-AG	10 1/4	1 1/2	8 1/2	12	14 1/4	4	78
B-1892-BL	B-1892-BG	13 1/4	1 1/2	11 1/2	15	17 1/4	4	105
B-1892-CL	B-1892-CG	16 1/4	1 1/2	14 1/2	18	20 1/4	4	136
B-1892-DL	B-1892-DG	18 1/4	1 1/2	16 1/2	20	22 1/4	4	179
B-1892-EL	B-1892-EG	22 1/4	1 1/2	20 1/2	24	26 1/4	4	240
B-1892-FL	B-1892-FG	25 1/4	1 1/2	23 1/2	27	29 1/4	4	280
B-1892-GL	B-1892-GG	28 1/4	1 1/2	26 1/2	30	32 1/4	4	334
B-1892-HL	B-1892-HG	34 1/4	1 1/2	32 1/2	36	38 1/4	4	429
B-1892-JL	B-1892-JG	40 1/4	1 1/2	38 1/2	42	44 1/4	4	572
B-1892-KL	B-1892-KG	46 1/4	1 1/2	44 1/2	48	50 1/4	4	736

B1650 Series - Top Flange

U.S. Government Standard Design

H-20 Loading		For Heavy Loads				
Table Dimensions in Inches						
Manhole Style	Cover Diameter "A"	Cover Thickness "B"	Clear Opening "C"	Ring Overall "D"	Ring Height "E"	Wt. lbs.
B-1650-A	21	2 1/2	18	27 1/2	5	305
B-1650-C	23	1 1/4	20	29 1/2	4	324
B-1650-D	27	1 1/4	24	33 1/2	4	275
B-1650-E	27	1 1/4	24	33 1/2	4	326
B-1650-F	27	2 1/2	24	33 1/2	5	456
B-1650-G	27	2 1/2	24	33 1/2	5	539
B-1650-H	29	1 1/4	27	35	6	545
B-1650-J	32 1/4	2	30	39 1/2	6	567

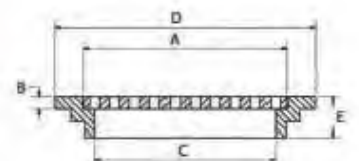

B1878B & B1879B Series - Bottom Flange

Manhole Style (Solid Lid)	Cover Dimensions "A"	Cover Thickness "B"	For Heavy Loads Table Dimensions in Inches				Wt. lbs.
			Cover Edge "C"	Base Opening "D"	Frame Overall "E"	Frame Depth "F"	
B-1878-B1	14 x 20	1 1/2	12 x 18	14 1/4 x 20 1/4	18 x 24	4	187
B-1878-B2	13 1/2 x 25 1/2	1 1/2	12 x 24	13 3/4 x 25 3/4	18 x 30	4	202
B-1878-B3	19 1/2 x 25 1/2	1 1/2	18 x 24	19 3/4 x 25 3/4	24 x 30	4	299
B-1878-B4	19 1/2 x 31 1/2	1 1/2	18 x 30	20 x 32	24 x 36	4	386
B-1878-B5	19 1/4 x 37 3/4	1 1/2	18 x 36	20 x 38	24 x 42	4	421
B-1878-B6	25 1/2 x 31 1/2	1 1/2	24 x 30	25 3/4 x 31 3/4	30 x 36	4	474
B-1988-B7	25 1/4 x 37 3/4	1 1/2	24 x 36	26 x 38	30 x 42	4	534
*B-1878-B8	25 1/4 x 49 3/4	1 1/2	24 x 48	26 x 50	30 x 54	4	621
*B-1878-B9	31 1/4 x 37 3/4	1 1/2	30 x 36	32 x 38	36 x 42	4	702
*B-1878-B10	31 1/4 x 49 3/4	1 1/2	30 x 48	31 1/4 x 49 3/4	36 x 54	4	868

B1878A & B1879A Series - Bottom Flange

Manhole Style (Solid Lid)	Cover Dimensions "A"	Cover Thickness "B"	For Heavy Loads Table Dimensions in Inches				Wt. lbs.
			Cover Edge "C"	Base Opening "D"	Frame Overall "E"	Frame Depth "F"	
B-1878-A1	13 1/2 x 13 1/2	1 1/2	12 x 12	14 x 14	18 x 18	4	148
B-1878-A2	18 x 18	1 1/2	16 x 16	18 1/4 x 18 1/4	22 x 22	4	201
B-1878-A3	20 x 20	1 1/2	18 x 18	20 1/4 x 20 1/4	24 x 24	4	243
B-1878-A4	21 1/4 x 21 1/4	1 1/2	20 x 20	22 x 22	26 x 26	4	299
B-1878-A5	23 1/4 x 23 1/4	1 1/2	22 x 22	24 x 24	28 x 28	4	337
B-1878-A6	25 1/4 x 25 1/4	1 1/2	24 x 24	26 x 26	30 x 30	4	412
B-1878-A7	27 1/4 x 27 1/4	1 1/2	26 x 26	28 x 28	32 x 32	4	457
*B-1878-A8	29 1/4 x 29 1/4	1 1/2	28 x 28	29 1/4 x 29 1/4	34 x 34	4	485
*B-1878-A9	31 1/4 x 31 1/4	1 1/2	30 x 30	32 x 32	36 x 36	4	529
*B-1878-A10	37 1/4 x 37 1/4	1 1/2	36 x 36	38 x 38	42 x 42	4	742

B1988B & B1989B Series - Top Flange

Manhole Style (Solid Lid)	Cover Dimensions "A"	Cover Thickness "B"	For Heavy Loads Table Dimensions in Inches				Wt. lbs.
			Cover Edge "C"	Base Opening "D"	Frame Overall "E"	Frame Depth "F"	
B-1988-B1	14 x 20	1 1/2	12 x 18	14 1/4 x 20 1/4	18 x 24	4	187
B-1988-B2	13 1/2 x 25 1/2	1 1/2	12 x 24	13 3/4 x 25 3/4	18 x 30	4	247
B-1988-B3	19 1/2 x 25 1/2	1 1/2	18 x 24	19 3/4 x 25 3/4	24 x 30	4	299
B-1988-B4	19 1/2 x 31 1/2	1 1/2	18 x 30	20 x 32 3/4	24 x 36	4	383
B-1988-B5	19 1/4 x 37 3/4	1 1/2	18 x 36	20 x 38	24 x 42	4	429
B-1988-B6	25 1/2 x 31 1/2	1 1/2	24 x 30	25 3/4 x 31 3/4	30 x 36	4	474
B-1988-B7	25 1/4 x 37 3/4	1 1/2	24 x 36	26 x 38	30 x 42	4	544
*B-1988-B8	25 1/4 x 49 3/4	1 1/2	24 x 48	26 x 50	30 x 54	4	632
*B-1988-B9	31 1/4 x 37 3/4	1 1/2	30 x 36	32 x 38	36 x 42	4	708
*B-1988-B10	31 1/4 x 49 3/4	1 1/2	30 x 48	31 1/4 x 49 3/4	36 x 54	4	888

B1988A & B1989A Series - Top Flange

Manhole Style (Solid Lid)	Cover Dimensions "A"	Cover Thickness "B"	For Heavy Loads Table Dimensions in Inches				Wt. lbs.
			Cover Edge "C"	Base Opening "D"	Frame Overall "E"	Frame Depth "F"	
B-1988-A1	13 1/2 x 13 1/2	1 1/2	12 x 12	14 x 14	18 x 18	4	148
B-1988-A2	18 x 18	1 1/2	16 x 16	18 1/4 x 18 1/4	22 x 22	4	201
B-1988-A3	20 x 20	1 1/2	18 x 18	20 1/4 x 20 1/4	24 x 24	4	243
B-1988-A4	21 1/4 x 21 1/4	1 1/2	20 x 20	22 x 22	26 x 26	4	299
B-1988-A5	23 1/4 x 23 1/4	1 1/2	22 x 22	24 x 24	28 x 28	4	334
B-1988-A6	25 1/4 x 25 1/4	1 1/2	24 x 24	26 x 26	30 x 30	4	405
B-1988-A7	27 1/4 x 27 1/4	1 1/2	26 x 26	28 x 28	32 x 32	4	457
B-1988-A8	29 1/4 x 29 1/4	1 1/2	28 x 28	29 1/4 x 29 1/4	34 x 34	4	480
B-1988-A9	31 1/4 x 31 1/4	1 1/2	30 x 30	32 x 32	36 x 36	4	539
*B-1988-A10	37 1/4 x 37 1/4	1 1/2	36 x 36	38 x 38	42 x 42	4	742

Catch Basin Frames & Grates
Heavy duty and light duty rectangular frame and cover or grate for built up construction. Most popular as a catch basin.

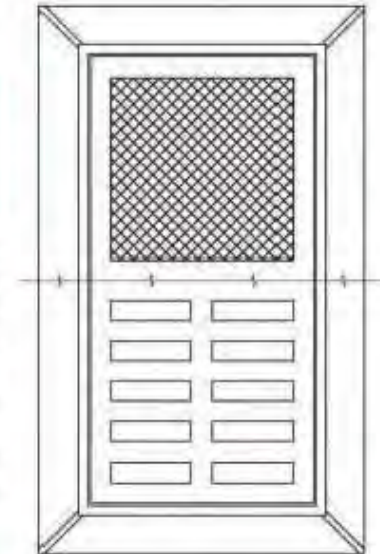

Loadings shown are for Gray and Ductile Cast Iron. For aluminum covers and grates: If H-20 Loading is required - it must be specified.

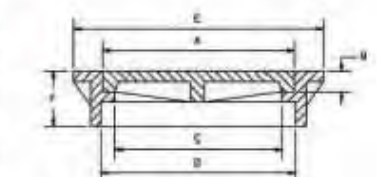
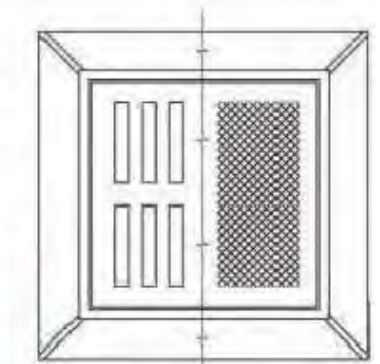

*Cover furnished in 2 pieces

Round

U.S. Government, Bell Telephone & Power Company Design.

BarryCraft's B-1640 meet the U.S. Governments standard designs. BarryCrafts B-1640 U.S. Gov't series in addition meets the Bell Telephone and Power Company's designs. These designs will support a H-20 loading.

B1640B Series - Bottom Flange

U.S. Government, Bell Telephone & Power Company Design

H-20 Loading

For Heavy Loads
Table Dimensions in Inches

Manhole Style	Cover Dimensions "A"	Cover Thickness "B"	Clearing Opening "C"	Base Opening "D"	Ring Overall "E"	Ring Height "F"	Wt. lbs.
B-1640-A	26	1 3/4	24	35	43	10	632
B-1640-B	29	1 3/4	27	38	46	10	708
B-1640-B1	29	1 3/4	27	34	46	5 3/4	637
B-1640-C	32	1 3/4	30	41	49	10	853
B-1640-C1	32	1 3/4	30	37	49	5 3/4	735
B-1640-D	38	1 3/4	36	40	50	10	945

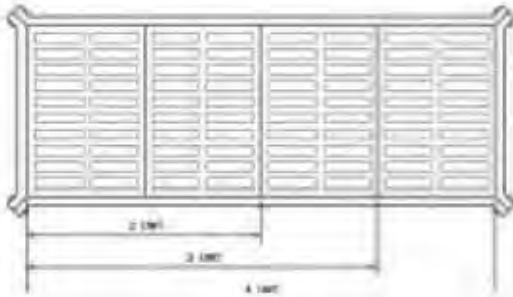
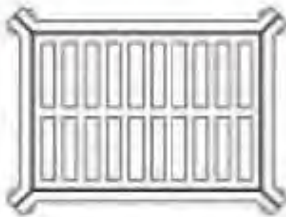
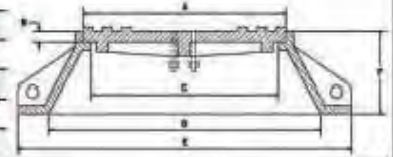
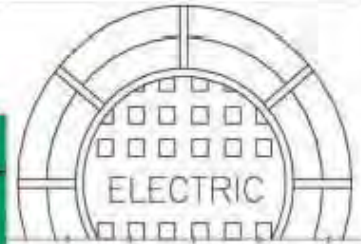

B-3485-A

B-3485-F 2 Grate Unit

B-3485-G 3 Grate Unit

B-3485-H 4 Grate Unit

B-3485-B,C, and D Grates Are Furnished As Ductile Iron

-Grates Can Be Furnished Bolted With Counter Sunk Hex Head Bolts

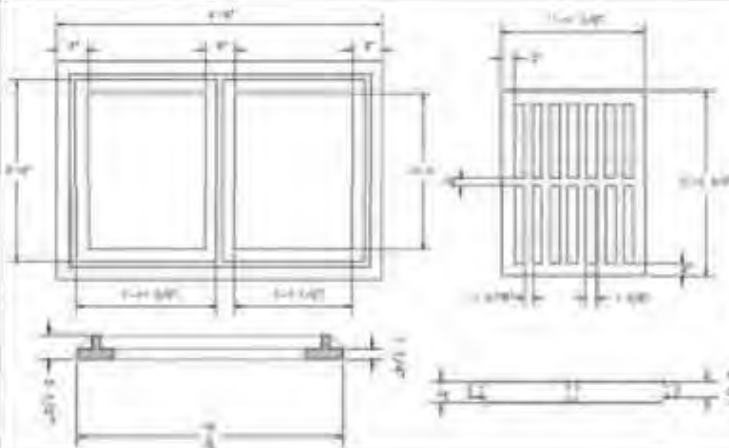
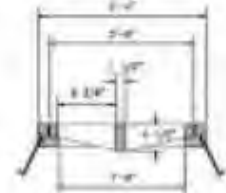
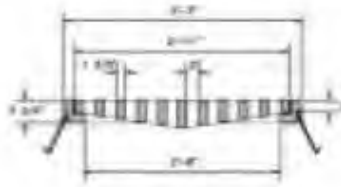

B-3492-A

-The Frame Can Be Furnished With Anchor Bolt Holes.

-The Grates Can Be Furnished Bolted With Counter Sunk Hex Head Bolts

Loadings shown are for Gray and Ductile Cast Iron, For aluminum covers and grates: If H-20 Loading is required - It must be specified.



Construction Casting Company
800-524-1809

Standard Curb Inlet Grates, Frames & Hoods

B-3256B - Curb Inlet Gate, Frame and Curb Box, 525 lbs.

Heavy duty. Most popular. Fits standard 18 inch gutter and has adjustable hood.

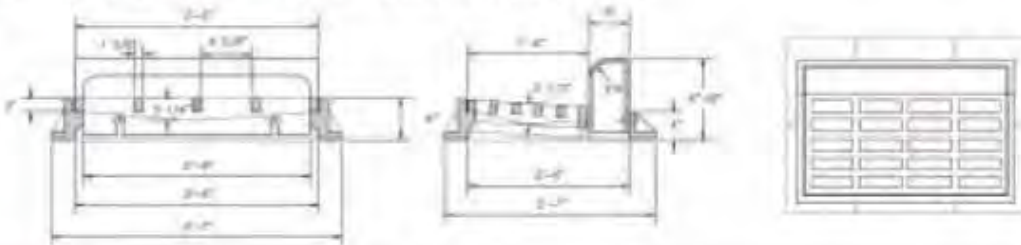

B-2400 - Rectangular Inlet Grate and Frame, 445 lbs.

Heavy duty. Excellent as catch basins in parking lots. Also used as gutter inlets.



B-3242 - Three Piece Curb Inlet Grate, Frame and Hood, 425 lbs.

Heavy duty three sided frame with grate and free standing hood.

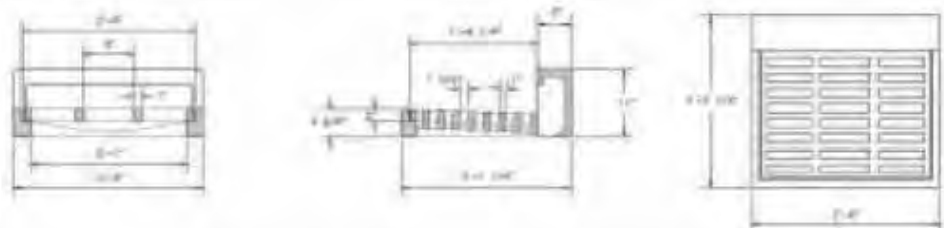

B-3256A - Curb Inlet Grate, Frame and Curb Box, 550 lbs.

Heavy duty. Similar to B-3256B except fits a 24 inch gutter. Provides extra drainage. Has adjustable hood.

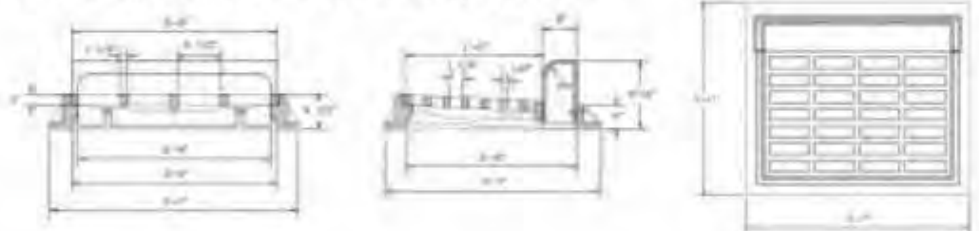

B-1867A - Square Inlet Grate and Frame, 475 lbs.

Heavy duty. Excellent as inlets in parking lots. (Also available with square holes. Specify B-1867B).





Curb and Sidewalk Guards B4984

Heavy curb and sidewalk guards provide excellent protection to concrete curbs and traffic islands subjected to vehicular abuse. Non-corrosive cast iron provides virtually permanent protection.

Available in straight or tapered face. Specify height, degree or taper and complete dimensions for curb or traffic island area. Curb guards supplied in straight and radius sections as required.

Stop Plank Grooves B7510 Series

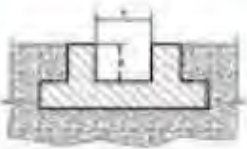
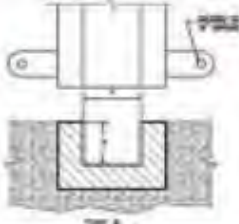
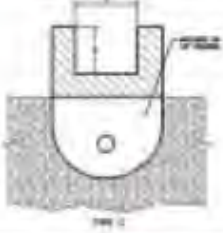
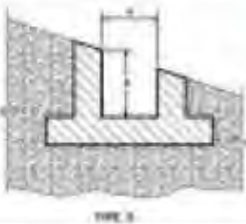
For sewage disposal: Barrycraft's standard stop plank grooves are offered in seven basic designs. Other designs are available upon request. Our stop plank grooves are supplied in standard 3 foot length or shorter to provide any overall length required. Standard groove width and depths are listed below. Other widths and depths are available upon request.

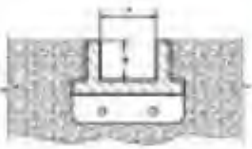
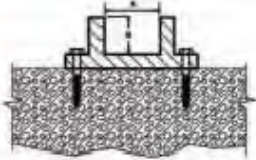
A		Standard Dimensions			B
		Width "A"	Height "B"		
		1 1/2"	1"		
		1 3/4"	1 1/4"		
C		2"	1 1/2"		D
		2 1/4"	1 3/4"		
		2 1/2"	2"		
		3"	2 1/2"		
E		3 1/2"	3"		G
		4"	4"		
		6"	6"		
		3 1/2"	3"		
L		Other sizes available upon request.			
		Maximum length per section is 3' long.			

Downspout Boots Gray Cast Iron & Cast Aluminum

B4924 Series

BarryCraft's gray cast iron and cast aluminum downspout boots are heavy duty and should last virtually the life of the building.

B25A	B25B	B25C	B25D
Pattern	Pattern	Pattern	Pattern
<p>Rectangular downspout to round discharge outlet is designed to empty straight into a soil pipe. This downspout boot is also designed with an offset from the building to allow the pipe hub to fit around the downspout boot. They may be used with PVC pipe. Check clearances in the table below.</p>	<p>Rectangular downspout to rectangular discharge outlet is designed to empty into a trench or gutter box at a 90° turn.</p>	<p>Rectangular downspout to round discharge outlet is designed to empty into a vitrified, concrete or soil pipe with a 90° turn. Downspout outlet is designed to fit into the hub of a standard soil pipe or PVC pipe. Call to verify diameter clearances.</p>	<p>Rectangular downspout to rectangular discharge outlet is designed to empty onto a splash block or paved area.</p>

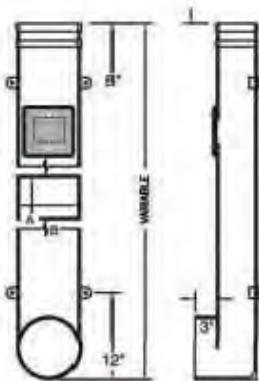

New - Now Available
Cleanouts available on
B-25 Series Downspout Boots
Castings 18" and longer

DOWNSPOUT BOOTS STYLE 25A STANDARD OUTLETS AVAILABLE			
Other sizes may be available upon request for the B25A downspout boots.			
DOWNSPOUT SIZE	OUTLET I.D.	OUTLET O.D.	OFFSET
A x B	C	D	E
3" x 3"	3"	4"	2½"
3" x 4"	4"	4⅞"	2½"
3" x 5"	5"	6"	2⅝"
4" x 4"	4"	4⅞"	2¼"
4" x 5"	4"	4⅞"	2½"
4" x 5"	5"	6"	2⅝"
4" x 6"	4"	4⅞"	1½"
4" x 6"	6"	6⅞"	1½"
5" x 5"	6"	7"	2½"
6" x 6"	6"	7"	1¼"

Standard Lengths 12" 18" 24" 30" 36" 42" 48" 54" 60" 72"

BarryCraft downspout boots are excellent in areas subjected to vehicular traffic where light duty downspout boots can be easily damaged. Our downspout boots are also excellent in public areas such as around buildings or schools where pedestrian traffic can vandalize light duty downspouts.

B26A

Pattern

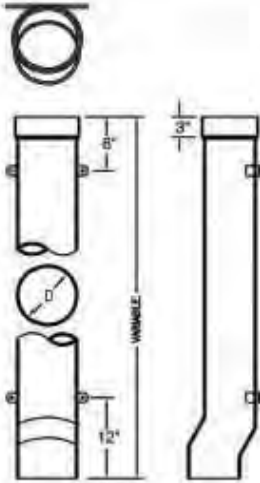

Round downspout to a round discharge is designed to empty straight down into a soil pipe. This downspout boot is also designed with a offset from the building to allow the pipe hub to fit around the Downspout boot. Standard offset 2½". PVC pipe may be used. Call to check clearances.

B26B

Pattern

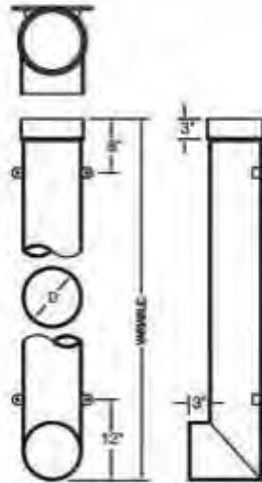

Round downspout to a round discharge to empty into a soil pipe at a 90 turn. The outlet is designed to fit into the hub of a standard soil pipe. PVC pipe may be used. Call to check clearances.

B26C

Pattern

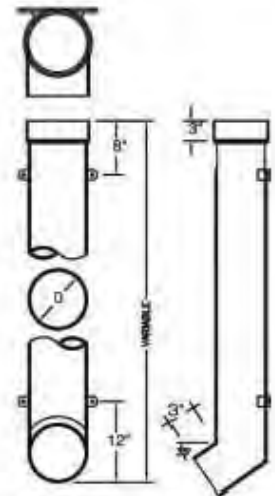

Round downspout to a round discharge is Designed to empty onto a splash block or paved area.

"D"

- 3" dia.
- 4" dia.
- 5" dia.
- 6" dia.

Standard Lengths 12" 18" 24" 30" 36" 42" 48" 54" 60" 72"

BarryCraft

Construction Casting Company
800-524-1809

The BarryCraft Line of Quality Cast Products Available in Cast Gray Iron or Aluminum

Heavy Duty Pipe Grates

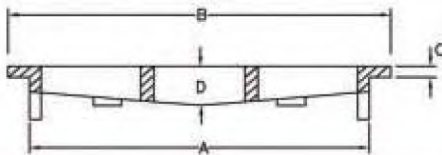

B-4042 HEAVY DUTY GRATES FOR THE END OF CORRUGATED PIPE OR PVC PIPE

PIPE SIZE	A	Overall DIA. (B)	Edge (C)	Center (D)	Total Wt.
6	5 $\frac{1}{2}$ "	7 $\frac{1}{2}$ "	$\frac{1}{2}$ "	$\frac{3}{8}$ "	12
8	7 $\frac{1}{2}$ "	10"	$\frac{3}{16}$ "	1 $\frac{1}{4}$ "	15
10	9 $\frac{1}{2}$ "	12"	$\frac{3}{8}$ "	1 $\frac{1}{2}$ "	25
12	11 $\frac{1}{2}$ "	14 $\frac{1}{2}$ "	$\frac{3}{8}$ "	1 $\frac{1}{2}$ "	34
15	14 $\frac{1}{2}$ "	17 $\frac{1}{2}$ "	$\frac{3}{8}$ "	1 $\frac{1}{2}$ "	50
18	17 $\frac{1}{2}$ "	20 $\frac{1}{2}$ "	$\frac{3}{8}$ "	1 $\frac{1}{2}$ "	75
24	23 $\frac{1}{2}$ "	26 $\frac{1}{2}$ "	$\frac{3}{8}$ "	2 $\frac{1}{4}$ "	130
30	29 $\frac{1}{2}$ "	32 $\frac{1}{2}$ "	1"	2 $\frac{3}{4}$ "	228
36	35 $\frac{1}{2}$ "	38 $\frac{1}{2}$ "	1 $\frac{1}{2}$ "	3"	325
42	41 $\frac{1}{2}$ "	44 $\frac{1}{2}$ "	1 $\frac{1}{2}$ "	4"	480
48	47 $\frac{1}{2}$ "	50 $\frac{1}{2}$ "	1 $\frac{1}{2}$ "	4 $\frac{1}{2}$ "	630

A = Pipe Size minus $\frac{1}{4}$ " Diameter

Tree Grates & Frames - Hundreds of Styles

Sunburst Design

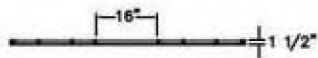
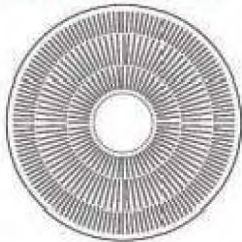

Concentric Design

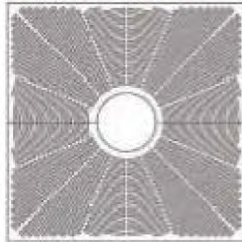

For sizes see Sweet's CD, sweets.com or order catalog.

Airport Drainage Inlet

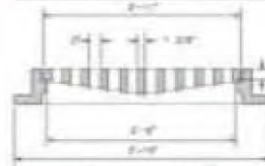
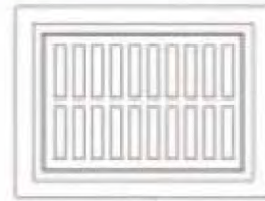

For sizes see Sweet's CD, sweets.com or order catalog.

Ductile Iron Grates can be Specified for Added Material Strength

B3485 Series

- Extra Heavy Duty
- Bottom Flange Frame with Grate Suitable for the Most Heavy Traffic Uses.
- Specify if Bolting is Required.

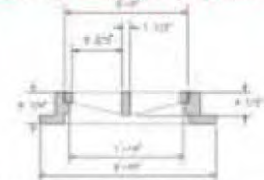

Cast Treads, Nosings & Thresholds

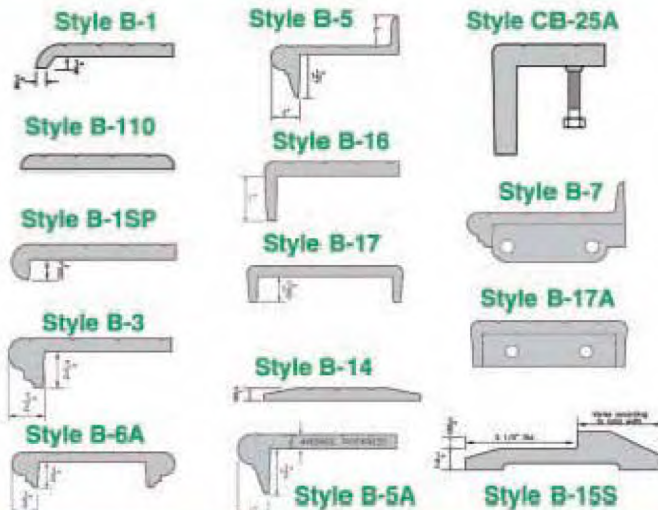

Barry Pattern & Foundry Company, Inc. 3333 35th Avenue North, Birmingham, AL 35207
Call Toll Free Outside Alabama: 1-800-524-1809 In Alabama: 205-841-8725
Fax: 205-841-1972